

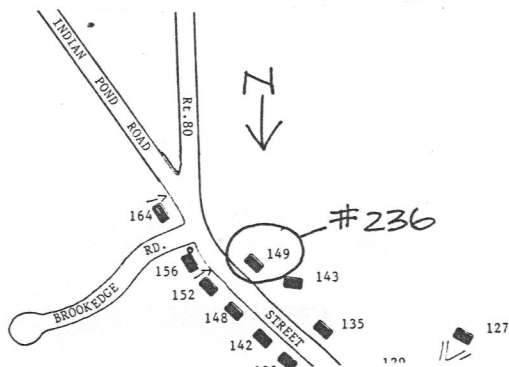

Sketch map

Draw a map showing the building's location in relation to the nearest cross streets and/or major natural features. Show all buildings between inventoried building and nearest intersection or natural feature. Label streets including route numbers, if any. Circle and number the inventoried building. Indicate north.



Recorded by Deirdre Brotherson

Organization Kingston Historical Commission

Date (month/year) May 1998

or's number

USGS Quad

Area(s)

Form Number

236

Town Kingston

Place (neighborhood or village)

Address 149 Elm Street

Historic Name Nathaniel Bryant House

Uses: Present residence

Original residence

Date of Construction c.1850

Source maps

Style/Form Greek Revival

Architect/Builder

Exterior Material:

Foundation granite

Wall/Trim wood clapboards

Roof asphalt shingles

Outbuildings/Secondary Structures  
barn

Major Alterations (with dates)

Condition good

Moved ☒ no ☐ yes

Date

Acreage 1.5 acres

Setting

linear neighborhood outside of village center - on road to Plympton

RECEIVED

AUG 25 1998

MASS. HIST. COMM

## BUILDING FORM

## ARCHITECTURAL DESCRIPTION

☒ *see continuation sheet*

*Describe architectural features Evaluate the characteristics of this building in terms of other buildings within the community.*

**SEE CONTINUATION SHEET**

## HISTORICAL NARRATIVE

☒ *see continuation sheet*

*Discuss the history of the building. Explain its associations with local (or state) history. Include uses of the building, and the role(s) the owners/occupants played within the community.*

**SEE CONTINUATION SHEET**

## BIBLIOGRAPHY and/or REFERENCES

☒ *see continuation sheet*

**SEE CONTINUATION SHEET**

☐ Recommended for listing in the National Register of Historic Places.  
a completed National Register Criteria Statement form.

*If checked, you must attach*

Massachusetts Historical Commission  
220 Morrissey Blvd.  
Boston, Massachusetts 02125

Area(s) FormNo.

236

**ARCHITECTURAL DESCRIPTION:**

The residence at 149 Elm Street was built c.1850 in the Greek Revival style. This 3x4 bay, wood frame, 2 story building sits on a brick foundation. The building is clad with clapboards and board and batten siding on the two porches. The cross gable roof is covered with asphalt shingles. Two brick chimneys are located at the ridge of the main block, one brick chimney is located at the center ridge of the rear ell. The entrance is located on the side elevation on a recessed porch. The door is flanked by half sidelights and topped by a transom. The windows contain 6/6 wood sash with flat surrounds. The corners are enhanced with pilasters. The cornice is boxed with returns. A bay window projects front the center of the facade. A handicapped ramp has been added to the west elevation. A 3x2 bay, wood frame, 2 story barn sits toward the rear of the property.

**HISTORICAL NARRATIVE:**

This house was built by Nathaniel Bryant, his brother Sylvanis Bryant built a house in a similar style at 22 Indian Pond Road (INV # 240). Local folklore states that the two brothers built these houses after returning from the California gold rush. The Bryant family owned much land in this area and held water privileges at Jones River where they had an anchor forge, sawmill and boxboard mill. The property was also farmed as is evident by the extant out buildings. This is a good example of the Greek revival style however, alterations have diminished its integrity (slate roof removed, new siding, secondary entrance added to east side). The house at 22 Indian Pond Road (#240) retains more of its architectural integrity.

**BIBLIOGRAPHY:**

Melville, Doris Johnson. Major Bradford's Town: A History of Kingston: 1726-1976. Kingston, MA., 1976. [KPL]

**MAPS:**

1726 Kingston. John Gray [MHC]

1795 A Plan of the Town of Kingston. John Gray. [MHC]

1820-30 Five School Districts [KPL]

1876 Town of Kingston. Boyden (w/directory). [KPL]

1876 Town of Kingston, Enlargement of Village. Boyden. [KPL]

1879 Atlas of Plymouth County. George E. Walker. [MHC]

1896 Bird's Eye View of Kingston [KPL & MSL]

1903 Atlas of Plymouth County. George E. Walker. [KPL]

