

Sketch Map

Draw a map showing the building's location in relation to the nearest cross streets and/or major natural features. Show all buildings between inventoried building and nearest intersection or natural feature. Label streets including route numbers, if any. Circle and number the

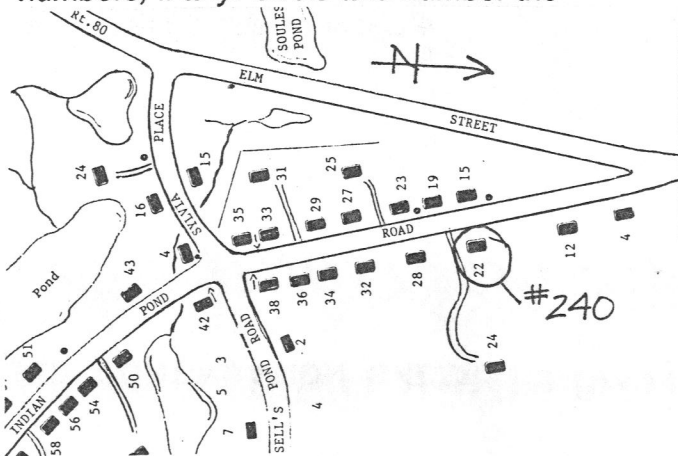

Recorded by Deirdre Brotherson

Organization Kingston Historical Commission

Date (month/year) May 1998

or's number

USGS Quad

Area(s)

Form Number

240

Town Kingston

Place (neighborhood or village)

Address 22 Indian Pond Road

Historic Name Sylvanus Bryant House

Uses: Present residence

Original residence

Date of Construction c.1850

Source maps

Style/Form Greek Revival

Architect/Builder

Exterior Material:

Foundation granite

Wall/Trim wood clapboard, shingle, flushboard

Roof slate shingles

Outbuildings/Secondary Structures
barn

Major Alterations (with dates)

Condition good

Moved ☒ no ☐ yes

Date

Acreage 10 acres

Setting

linear neighborhood outside of village center

RECEIVED

AUG 25 1998

MASS. HIST. COMM

Follow Massachusetts Historical Commission Survey Manual instructions when completing this form.

KIN.240

BUILDING FORM

ARCHITECTURAL DESCRIPTION

☒ *see continuation sheet*

Describe architectural features Evaluate the characteristics of this building in terms of other buildings within the community.

SEE CONTINUATION SHEET

HISTORICAL NARRATIVE

☒ *see continuation sheet*

Discuss the history of the building. Explain its associations with local (or state) history. Include uses of the building, and the role(s) the owners/occupants played within the community.

SEE CONTINUATION SHEET

BIBLIOGRAPHY and/or REFERENCES

☒ *see continuation sheet*

SEE CONTINUATION SHEET

☒ Recommended for listing in the National Register of Historic Places.
a completed National Register Criteria Statement form.

If checked, you must attach

Massachusetts Historical Commission
220 Morrissey Blvd.
Boston, Massachusetts 02125

Area(s) FormNo.

240

ARCHITECTURAL DESCRIPTION:

The residence at 22 Indian Pond Road was built in 1850 in the Greek Revival style. This 4x5 bay, wood frame, 2 story building sits on a granite block foundation. The building is clad with wood clapboards and shingles. The cross-gable roof is covered with slate shingles. The building has three brick chimneys; two at the ridge of the main house and one at the ridge of the rear ell. The main entrance is located on the south elevation recessed in a porch. The entrance contains a 4 panel Greek Revival style wood door flanked by half sidelights with a flat surround and molded drip edge. The first floor, front room windows contain 6/9 floor-ceiling wood sash. The remainder of the windows contain 6/6 sash. The building is articulated with corner pilasters and a wide frieze with a boxed cornice with returns. The recessed porch which flanks the front room is supported by Doric columns. A bay window projects from the south elevation, first floor. An ell attached to the rear of the building contains a contemporary kitchen and bath. A large 3x4 bay, wood frame, 2 story gable roof barn is at the rear of the property. A three stall garage was added to the property in 1997.

flushboard

Greek Revival was the dominant style of American domestic architecture during the interval from about 1830 to 1860. The final years of the 18th century brought an increasing interest in classical buildings to both the United States and western Europe. This was first based on Roman models, but archaeological investigation in the early 19th century emphasized Greece as the Mother of Rome which, in turn, shifted interest to Grecian models. Two additional factors enhanced Greek influence in this country. Greece's involvement in a war for independence (1821-30) aroused much sympathy in the newly independent United States; at the same time, the War of 1812 diminished American affection for British influence, including the still dominant Federal style in domestic architecture. Features of the Greek Revival style include a gable roof with a cornice line emphasized with wide band of trim, most have porches supported by prominent square or rounded columns, typically Doric style; a front door surrounded by narrow, often full length sidelights with a rectangular line of transom lights above. An important enduring legacy of the Greek Revival to American domestic architecture is the front-gable house. Placing the narrow end of the building on the street enabled more buildings to be built on increasingly crowded streets and city blocks.

HISTORICAL NARRATIVE:

This house was built by Sylvanus Bryant c.1850. This is similar in plan to 149 Elm Street (INV#236) built by Nathaniel Bryant, his brother. Local folklore states that the two brothers built these houses after returning from the California gold rush. The Bryant family owned much land in this area and held water privileges at Jones River where they had an anchor forge, sawmill and boxboard mill. The property has been owned by several families in the 20th century: 1934 Ethel C. Bearce, 1936 Margaret Downes, 1943 Charles & Pearl Cherry, 1964 Pearl Perry, 1977 Charles & Janet Dickson, 1982 Daune Brotherson & William Frey (present owners).

This is one of the best examples of the Greek Revival residential architecture in Kingston. The other examples of the Greek Revival style are closer to the center of town and in a more urban setting. This is one example of Greek Revival in a rural setting. Most of the original materials remain intact and the house retains its architectural integrity.

BIBLIOGRAPHY:

Foster, Helen. Kingston Reporter. various articles recording a walking tour of Kingston, MA, 1984.

Then & Now - from Kingston Reporter - 1984 various dates

Melville, Doris Johnson. Major Bradford's Town: A History of Kingston: 1726-1976. Kingston, MA., 1976. [KPL]

MAPS:

1726 Kingston. John Gray [MHC]

1795 A Plan of the Town of Kingston. John Gray. [MHC]

1820-30 Five School Districts [KPL]

1876 Town of Kingston. Boyden (w/directory). [KPL]

1876 Town of Kingston, Enlargement of Village. Boyden. [KPL]

1879 Atlas of Plymouth County. George E. Walker. [MHC]

1896 Bird's Eye View of Kingston [KPL & MSL]

1903 Atlas of Plymouth County. George E. Walker. [KPL]

MHC INVENTORY FORM CONTINUATION SHEET

MHC Inventory scanning project, 2008-2012

MACRIS No. KIN.240



KIN.240

Massachusetts Historical Commission
220 Morrissey Blvd.
Boston, Massachusetts 02125

Community Property Address
Kingston 22 Indian Pond Road

Area(s)	FormNo.
	240

National Register of Historic Places Criteria Statement Form

Check all that apply:



- ☒ Individually eligible ☐ Eligible only in a historic district
☐ Contributing to a potential historic district ☐ Potential historic district

Criteria: ☐ A ☐ B ☒ C ☐ D

Criteria Considerations: ☐ A ☐ B ☐ C ☐ D ☐ E ☐ F ☐ G

Statement of Significance by Deirdre Brotherson

The criteria that are checked in the above sections must be justified here.

This property may be individually eligible for the National Register of Historic Places under Criterion C as an excellent example of the Greek Revival style. This is one of the best preserved rural examples of the style in Kingston.