

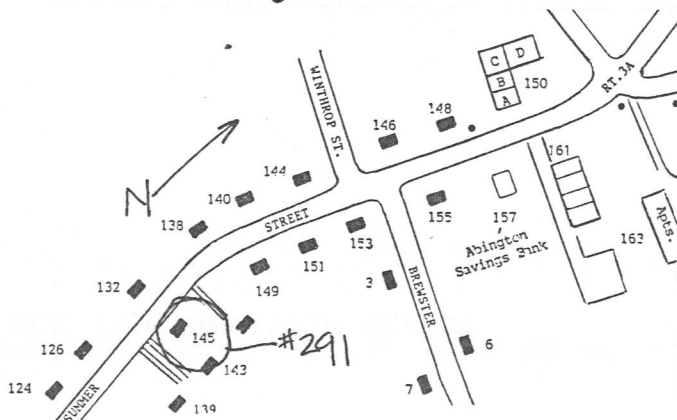

Draw a map showing the building's location in relation to the nearest cross streets and/or major natural features. Show all buildings between inventoried building and nearest intersection or natural feature. Label streets including route numbers, if any. Circle and number the inventoried building. Indicate



Recorded by Deirdre Brotherson

Organization Kingston Historical Commission

Date (month/year) May 1998

or's number

USGS Quad

Area(s)

Form Number

291

Town Kingston

Place (neighborhood or village)

Address 145 Summer Street

Historic Name C. H. Childs House

Uses: Present residence

Original residence

Date of Construction c.1900

Source maps

Style/Form Queen Anne cottage

Architect/Builder

Exterior Material:

Foundation brick

Wall/Trim wood shingles

Roof asphalt shingles

Outbuildings/Secondary Structures

Major Alterations (with dates)

rear addition - late 20th century

Condition good

Moved ☒ no ☐ yes

Date

Acreage 1 acre

Setting

linear village near railroad

RECEIVED

AUG 25 1998

Follow Massachusetts Historical Commission Survey Manual instructions when completing this form.

MASS. HIST. COMM

BUILDING FORM

ARCHITECTURAL DESCRIPTION

☒ *see continuation sheet*

Describe architectural features. Evaluate the characteristics of this building in terms of other buildings within the community.

SEE CONTINUATION SHEET

HISTORICAL NARRATIVE

☒ *see continuation sheet*

Discuss the history of the building. Explain its associations with local (or state) history. Include uses of the building, and the role(s) the owners/occupants played within the community.

SEE CONTINUATION SHEET

BIBLIOGRAPHY and/or REFERENCES

☒ *see continuation sheet*

SEE CONTINUATION SHEET

☐ Recommended for listing in the National Register of Historic Places.
a completed National Register Criteria Statement form.

If checked, you must attach

Massachusetts Historical Commission
220 Morrissey Blvd.
Boston, Massachusetts 02125

Area(s) FormNo.

291

ARCHITECTURAL DESCRIPTION:

The residence at 145 Summer Street was built c.1900 as a Queen Anne cottage. This 3x4 bay, wood frame, 2 story building sits on a brick foundation. The building is clad with wood shingles with a horizontal belt course between the 1st and 2nd floors. The side gable roof is covered with asphalt shingles. A brick chimney is located at the center ridge. The entrance is recessed on a entrance porch which is formed under the slope of the gable roof. The two bays adjacent to the entrance project from the building wall in a two story gable bay. The entrance contains an early 20th century wood bay with a large, square glass pane in the upper section. The entry porch is supported by turned brackets. The windows contain 2/1 vinyl replacement windows with flat surrounds. A Queen Anne window with a colored glass boarder is adjacent to the entry and a second one is found in a shed roof dormer above the entry. A two story rear ell and one story screen porch are new additions to the building.

HISTORICAL NARRATIVE:

This is a typical building form built in the early 20th century. Machine made lumber and building elements were easily acquired and put together in a variety of forms. This building was built by C.H. Childs. Information of Childs was not available. The house has been altered and a rear addition has displaced the balance of the original building form.

BIBLIOGRAPHY:

MAPS:

1726 Kingston. John Gray [MHC]

1795 A Plan of the Town of Kingston. John Gray. [MHC]

1820-30 Five School Districts [KPL]

1876 Town of Kingston. Boyden (w/directory). [KPL]

1876 Town of Kingston, Enlargement of Village. Boyden. [KPL]

1879 Atlas of Plymouth County. George E. Walker. [MHC]

1896 Bird's Eye View of Kingston [KPL & MSL]

1903 Atlas of Plymouth County. George E. Walker. [KPL]

Sanborn Insurance Company Maps:

Plymouth: 1896 June

1901 April (1896, 1901, 1906 include Kingston Village

1906 Feb. and Factories in Kingston)

Kingston: 1912 (6 sheets)

1925 (7 sheets)

1943 (7 sheets)

1954 (8 sheets)

