

essor's number

USGS Quad

Area(s)

Form Number

303

Town Kingston

Place (neighborhood or village)

Address 15 Landing Road

Historic Name The Poor House

Uses: Present residence

Original residence

Date of Construction c. 1772 +/-

Source maps & local history

Style/Form Federal style

Architect/Builder

Exterior Material:

Foundation unknown

Wall/Trim wood shingles

Roof wood shingles

Outbuildings/Secondary Structures
pool house

Major Alterations (with dates)
c. 1830 north end extended

Condition good

Moved ☒ no ☐ yes

Date

Acreage 1.5 acres

Setting

linear neighborhood - road runs parallel with
Jones River

Recorded by Deirdre Brotherson

Organization Kingston Historical Commission

Date (month/year) May 1998

MASS. HIST. COMM.

AUG 25 1998

AUG 25 1998

Follow Massachusetts Historical Commission Survey Manual instructions when completing this form.

MASS. HIST. COMM.

RECEIVED

BUILDING FORM

ARCHITECTURAL DESCRIPTION ☒ *see continuation sheet*

Describe architectural features Evaluate the characteristics of this building in terms of other buildings within the community.

SEE CONTINUATION SHEET

HISTORICAL NARRATIVE ☒ *see continuation sheet*

Discuss the history of the building. Explain its associations with local (or state) history. Include uses of the building, and the role(s) the owners/occupants played within the community.

SEE CONTINUATION SHEET

BIBLIOGRAPHY and/or REFERENCES ☒ *see continuation sheet*

SEE CONTINUATION SHEET

☐ Recommended for listing in the National Register of Historic Places.
a completed National Register Criteria Statement form.

If checked, you must attach

Massachusetts Historical Commission
220 Morrissey Blvd.
Boston, Massachusetts 02125

Area(s) FormNo.

303

ARCHITECTURAL DESCRIPTION:

The residence at 15 Landing Road was built, at least in part, c.1772. This 5x2 bay, wood frame, 2 story building is clad with wood shingles, the side gable roof is also covered with wood shingles. A massive brick chimney is located at the ridge on the southern end of the house. A smaller brick chimney is located at the ridge in the northern end of the house. The center entrance is flanked by fluted pilasters with a transom and pediment above. The windows contain 12/12 sash with wood shutters and flat surrounds. The cornerboards are thin and flat. A ell is attached to the rear of the building but details were not visible from the street.

HISTORICAL NARRATIVE:

According to local historians there are two stories about the origin of this house. The first, written by Emily Drew, is that the house, supposedly built about 1708 or 1710, was moved to the site from someplace else in the area. However, according to historian Doris Johnson, Zenus Drew, one of the 6 sons of Cornelius Drew, a shipbuilder, built the house on this site which he purchased from Samuel Drew in 1772. Based on exterior examination of the property, both ideas may have merit. This is a massive house to be built in the 18th century. It is possible that part of the house is a building which was moved to this site and then added onto. According to Johnson the north end of the building was extended c.1830 but the basis for that information is unknown. The placement of the chimneys is interesting. A examination of the internal framing or details of the building may shed light on its evolution. In 1827 the property was sold to the town as a house for the poor. The poor house was closed in the 1920's when legislation established other means of caring for the poor. Edward Wilbur Dean Hamilton purchased the property in 1923 for \$1500. In 1946 Louise Esterbrook Peck and Henry Peck, a famous illustrator, purchased the property. During the mid-20th century an art studio was added to the rear of the property. In 1961 Preston and Thelma Esterbrooks inherited the property.

BIBLIOGRAPHY:

Melville, Doris Johnson. Major Bradford's Town: A History of Kingston: 1726-1976. Kingston, MA., 1976. [KPL]

MAPS:

1726 Kingston. John Gray [MHC]

1795 A Plan of the Town of Kingston. John Gray. [MHC]

1820-30 Five School Districts [KPL]

1876 Town of Kingston. Boyden (w/directory). [KPL]

1876 Town of Kingston, Enlargement of Village. Boyden. [KPL]

1879 Atlas of Plymouth County. George E. Walker. [MHC]

1896 Bird's Eye View of Kingston [KPL & MSL]

1903 Atlas of Plymouth County. George E. Walker. [KPL]

FORM B - BUILDING

MASSACHUSETTS HISTORICAL COMMISSION
Office of the Secretary, State House, Boston

PL KING
USGS Plymouth
USDA

KIN.303

In Area no.	Form no.
	15

303



1. Town Kingston
Address 15 Landing Road
Name The Poorhouse
Present use private residence
Present owner Preston Easterbrooks

3. Description:

Date 1772
Source town records
Style originally 3/4 Colonial
Architect _____
Exterior wall fabric shingle & clapboard
Outbuildings (describe) cabana-toolshed
(former "tramphouse")
Other features _____

4. Map. Draw sketch of building location in relation to nearest cross streets and other buildings. Indicate north.

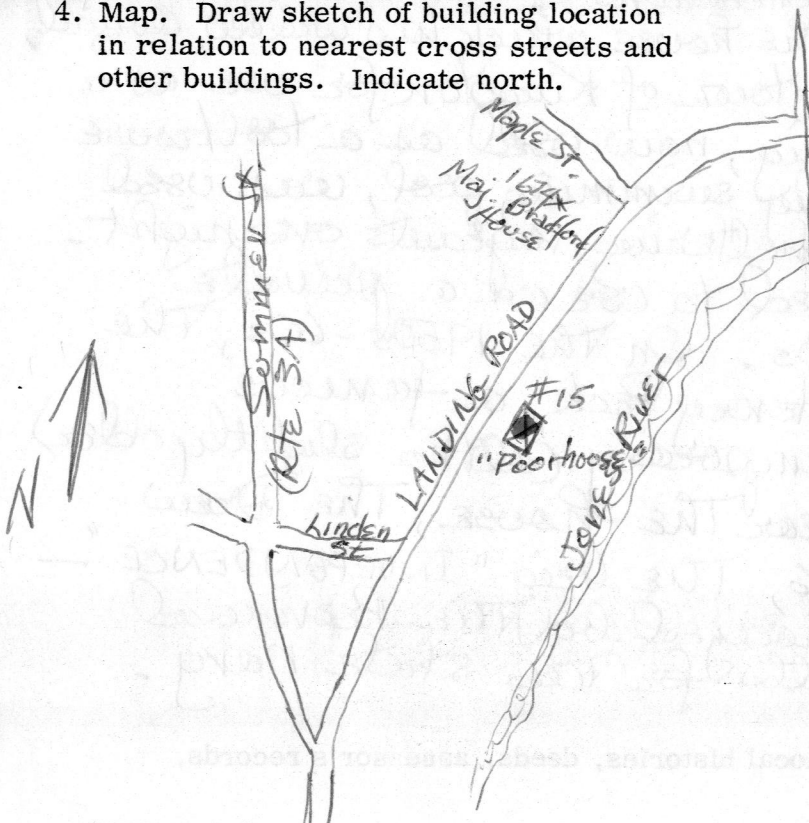

Altered north end extends Date c. 1830
art studio added at rear Date c. 1960
Moved _____ Date _____

5. Lot size: 1.5 a.
One acre or less _____ Over one acre ☒
Approximate frontage 175'
Approximate distance of building from street 150'

6. Recorded by Korreckthorne / Alanson
Organization DRV Historical Society
Date 12-18-78

DO NOT WRITE IN THIS SPACE
USGS Quadrant _____
MHC Photo no. _____

(over)

7. Original owner (if known) Zenas DrewOriginal use residenceSubsequent uses (if any) and dates Town Poorhouse 1827-1920s

8. Themes (check as many as applicable)

Aboriginal	<input type="checkbox"/>	Conservation	<input type="checkbox"/>	Recreation	<input type="checkbox"/>
Agricultural	<input type="checkbox"/>	Education	<input type="checkbox"/>	Religion	<input type="checkbox"/>
Architectural	<input type="checkbox"/>	Exploration/	<input type="checkbox"/>	Science/	<input type="checkbox"/>
The Arts	<input checked="" type="checkbox"/>	settlement	<input type="checkbox"/>	invention	<input type="checkbox"/>
Commerce	<input type="checkbox"/>	Industry	<input checked="" type="checkbox"/>	Social/	<input type="checkbox"/>
Communication	<input type="checkbox"/>	Military	<input checked="" type="checkbox"/>	humanitarian	<input type="checkbox"/>
Community development	<input checked="" type="checkbox"/>	Political	<input type="checkbox"/>	Transportation	<input checked="" type="checkbox"/>

9. Historical significance (include explanation of themes checked above)

Zenas Drew, one of 6 sons of Cornelius Drew — a shipbuilding family — paid his grandfather Samuel, ¹⁷⁷² in 1772 for this portion of the Jones R. bank where 3 generations of the Drew family built ships. Zenas built the house which his widow, Abigail, sold for \$900 in 1827 to the town of Kington for use as a "poor house". An outbuilding, now used as a tool house and cabana for the nearby swimming pool, was used as a "cramphouse" for sheltering vagrants overnight. The house was returned to use as a private residence in the 1920s. In the 1950s-60s, the house was owned by Henry Peck, a famous illustrator — a contemporary (alho slightly older) of Norman Rockwell. Near the house, the Drew brothers built, in 1776, the brig "INDEPENDENCE" — one of five vessels authorized by the Provincial Congress of Massachusetts for the state navy.

10. Bibliography and/or references (such as local histories, deeds, assessor's records, early maps, etc.)

local history manuscripts
Registry of Deeds
maps

Massachusetts Historical Commission
220 Morrissey Blvd.
Boston, Massachusetts 02125

Community Property Address
Kingston 15 Landing Road

KIN.303

Area(s)	FormNo.
	303

National Register of Historic Places Criteria Statement Form

Check all that apply:



- | | |
|--|---|
| <input checked="" type="checkbox"/> Individually eligible | <input type="checkbox"/> Eligible only in a historic district |
| <input type="checkbox"/> Contributing to a potential historic district | <input type="checkbox"/> Potential historic district |

Criteria: ☒ A ☐ B ☒ C ☐ D

Criteria Considerations: ☐ A ☐ B ☐ C ☐ D ☐ E ☐ F ☐ G

Statement of Significance by Deirdre Brotherson

The criteria that are checked in the above sections must be justified here.

This property may be individually eligible for the National Register of Historic Places under Criterion C as an excellent example of an early federal building with possible expansion during the early 1800's. This property may also be individually eligible for the National Register of Historic Places under Criterion A with its association with the movement which caused towns to create Poor Houses as a method to affect social change.