

Town Kingston 1<sup>st</sup> Ass. KIN.901

Street Howlands Lane

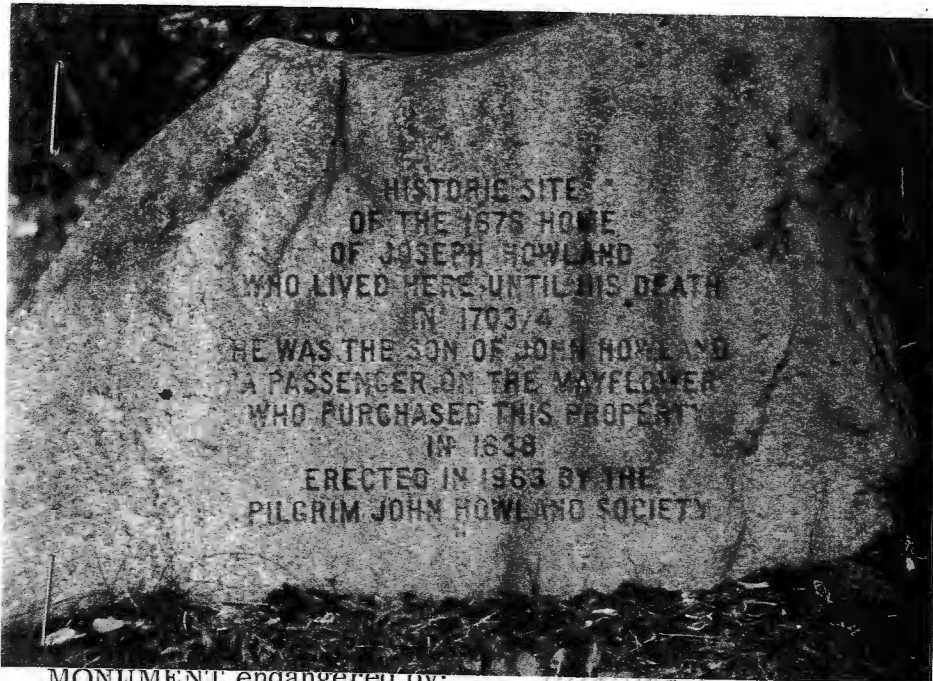

Howlands Sites

Number                     

Organization John Howland Soc.

Year Erected 1963

Material                     

Monument Type Monument

Sculptor                     

Group responsible for monument                       
 and owner                     

Registered                     

MONUMENT endangered by:                     

LOCATION OF INSCRIPTION: Plaque on wall, house, post; base of monument; other                     

ENTIRE INSCRIPTION on monument: Historic Site of the 1676 Home of Joseph Howland who lived here until his death in 1703/04 He was the son of John Howland a passenger of the Mayflower who purchased this property in 1638 Erected in 1963 by the Pilgrim John Howland Society

DESCRIPTION\*\*  
 Foundation: Pedestal Base None Material                       
 Material: Bronze Stone Marble Granite Wood Other                       
 Setting (surroundings) meadow  
 Size (approximate) 3' long 2' high

Indicate location of monument on map below

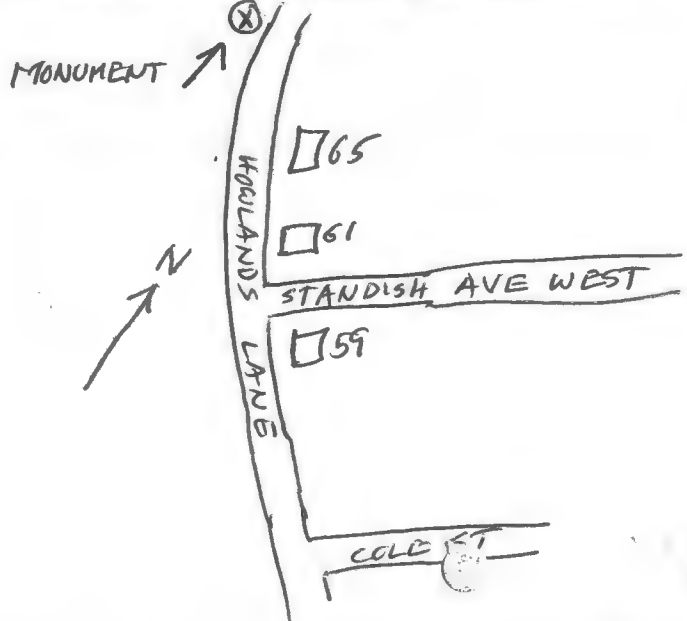

Recorder C. J. Valla CHRM.

For Kingston Hist Comm  
 (Name of Organization)

Photo                      Date Received                     

\* If the monument has been moved, indicate the original location on the reverse side.  
 \*\* Describe the monument on the reverse side.

GIVE A BRIEF DESCRIPTION OF SUBJECT MATTER AND/OR DESIGN OF MONUMENT

GIVE A BRIEF DESCRIPTION OF HISTORIC IMPORTANCE OF MONUMENT. (Refer to the theme circled on front of form. What happened? Who was important? Comment)

*Party member of the  
... ..*

REFERENCE: (Where was this information obtained? What book, records, etc.)



KIN 901 901  
PI 10221

SION  
ston

Town Kingston

Street Howlands Lane US63

Name Howland Sites - Ann 3/11  
S627

Original Owner \_\_\_\_\_

KER  
Present Owner John Howland Soc.

the  
Date Constructed 1963

Date Dedicated "

ion  
Source of Date Monument

Designer or Sculptor \_\_\_\_\_

n/City Individual or group responsible for monument  
if other than owner \_\_\_\_\_

eriorated Moved\* Altered \_\_\_\_\_

eat Moderate None \_\_\_\_\_

-----  
wall, house, post; base of monument; other \_\_\_\_\_

ENTIRE INSCRIPTION on monument: Historic site of the 1676 Home of Joseph Howland who lived here until his death in 1703/04 He was the son of John Howland A passenger of the Mayflower who purchased this property in 1638 Erected in 1963 By the Pilgrim John Howland Society

DESCRIPTION\*\*  
 Foundation: Pedestal Base None Material \_\_\_\_\_  
 Material: Bronze Stone Marble Granite Wood Other \_\_\_\_\_  
 Setting (surroundings) meadow  
 Size (approximate) 3' long 2' high

Indicate location of monument on map below

Recorder EJ Valla CHRMN.

For Kingston Hist Comm  
(Name of Organization)

Photo \_\_\_\_\_ Date Received \_\_\_\_\_

\* If the monument has been moved, indicate the original location on the reverse side.  
 \*\* Describe the monument on the reverse side.

GIVE A BRIEF DESCRIPTION OF SUBJECT MATTER AND/OR DESIGN OF MONUMENT

GIVE A BRIEF DESCRIPTION OF HISTORIC IMPORTANCE OF MONUMENT. (Refer to the theme circled on front of form. What happened? Who was important? Comment)

Early settler of the area.

REFERENCE: (Where was this information obtained? What book, records, etc.)